

# CF CASSETTE / FASCIA SUITE

# PRODUCT SPECIFICATIONS



February 2019



# CONTENTS

February 2019

SECTION NO.	DESCRIPTION	PAGE NO.
<b>SECTION 1 – OVERVIEW</b>		<b>1.1</b>
	PART A – GENERAL SCHEMATICS	1.1
	PART B – SYSTEM OPTIONS	1.3
	PART C – PRODUCT OPTIONS	1.3
	PART D – SYSTEM UPGRADES	1.4
<b>SECTION 2 – SYSTEM SPECIFICATIONS</b>		<b>2.1</b>
	PART A – CASSETTE 90 SPRING CAPACITY	2.1
	PART B – CASSETTE 90 CHAIN CONTROL CAPACITY	2.4
	PART C – CASSETTE 90 CHAIN CONTROL + RETROFIT BOOSTER CAPACITY	2.5
<b>SECTION 3 – TEST SUMMARY</b>		<b>3.8</b>
<b>SECTION 4 – MATERIAL SPECIFICATIONS</b>		<b>4.1</b>
<b>SECTION 5 – WARRANTY</b>		<b>5.1</b>
<b>SECTION 6 – SPECIFICATION IMAGES</b>		<b>6.1</b>
	PART A – SHADE DEDUCTIONS	6.1
	PART B – EASY-LINK ADDITIONAL DEDUCTION ALLOWANCE (CASSETTE 90 ONLY)	6.1
	PART C – MAXIMUM ROLL DIAMETERS	6.2
	PART D – BRACKET DIMENSIONS	6.2
	PART E – ARCHITECTURAL VIEWS	6.3
<b>SECTION 7 - PRODUCT IMAGERY</b>		<b>7.4</b>
<b>SECTION 8 – MEASURE &amp; SPECIFY</b>		<b>8.1</b>

## DISCLAIMER

### INTRODUCTION

This product specifications manual has been produced by Rollease Acmeda to supply the necessary information for safe and correct assembly and installation of this system.

### DISCLAIMER

Rollease Acmeda has used reasonable care in preparing the information included in this document, but makes no representations or warranties as to the completeness or accuracy of the information. Information is supplied upon the condition that the persons receiving the information will make their own determination as to its suitability for their purposes prior to use. Rollease Acmeda assumes no liability whatsoever for any damages incurred by you resulting from errors in or omissions from the information included herein. Rollease Acmeda reserves the right to make changes without further notice to any products to improve reliability, function or design.

### COPYRIGHT

COPYRIGHT © ROLLEASE ACMEDA 2019

All rights reserved. No part of this document may be reproduced or utilized in any means, by any means, electronic or mechanical including photocopying, recordings, or by any information storage or retrieval system, without the express permission from Rollease Acmeda.



## SECTION 1 – OVERVIEW

### PART A – GENERAL SCHEMATICS

Rollease Acmeda's new cassette roller suite offers a comprehensive range of head box styles, controls and side channel options with improved performance functionality and aesthetics. A contemporary round or square headbox; available in fully enclosed cassette or fascia only options, designed to house the most commonly used small and medium roller systems. Utilizing versatile hardware, the new cassette suite can be matched with CF90 Edge side channels for improved energy efficiency.

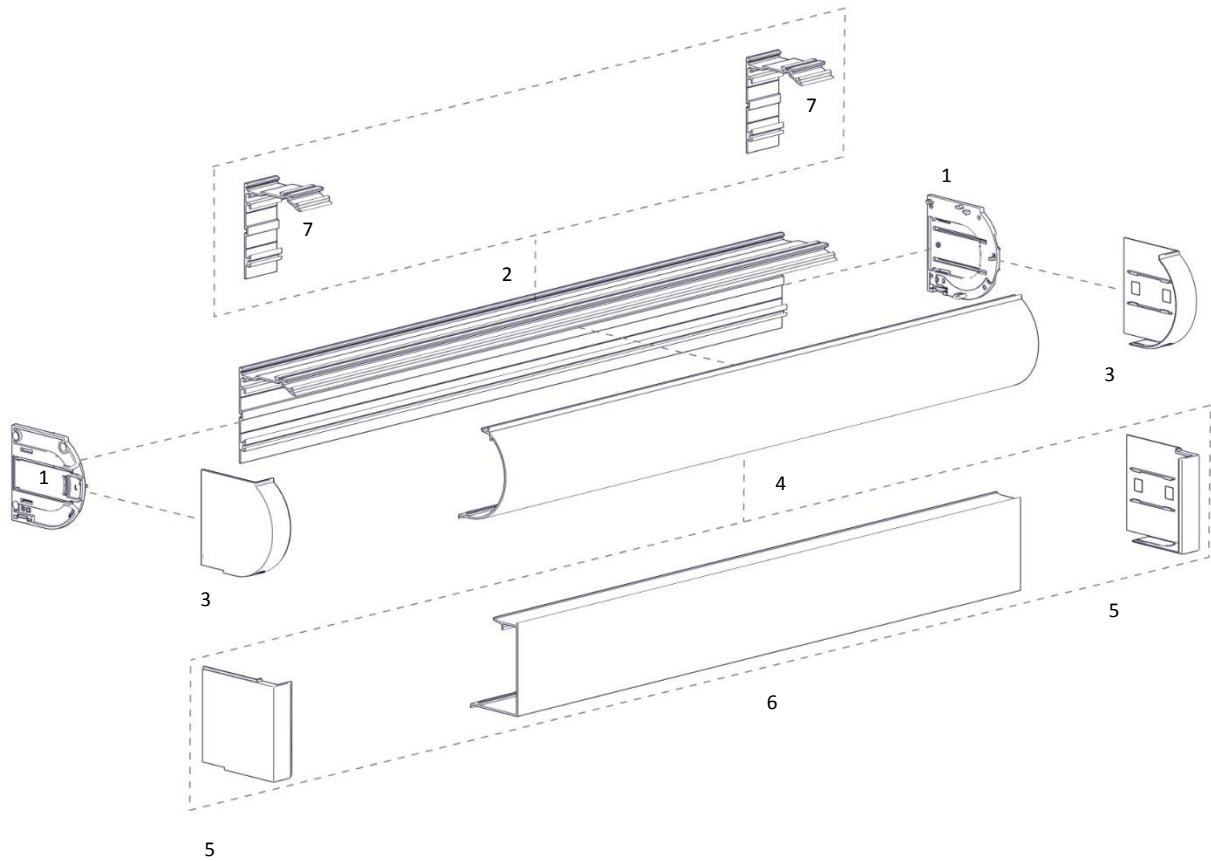

#### SYSTEM INDEX

##### CASSETTE 90

1. Cassette 90 End Plate Set
2. Cassette 90 Back
3. Cassette 90 Round End Cap
4. Cassette 90 Round Cover
5. Cassette 90 Square End Cap
6. Cassette 90 Square Cover
7. Cassette 90 Fascia Bracket 40mm



CF90 Edge System

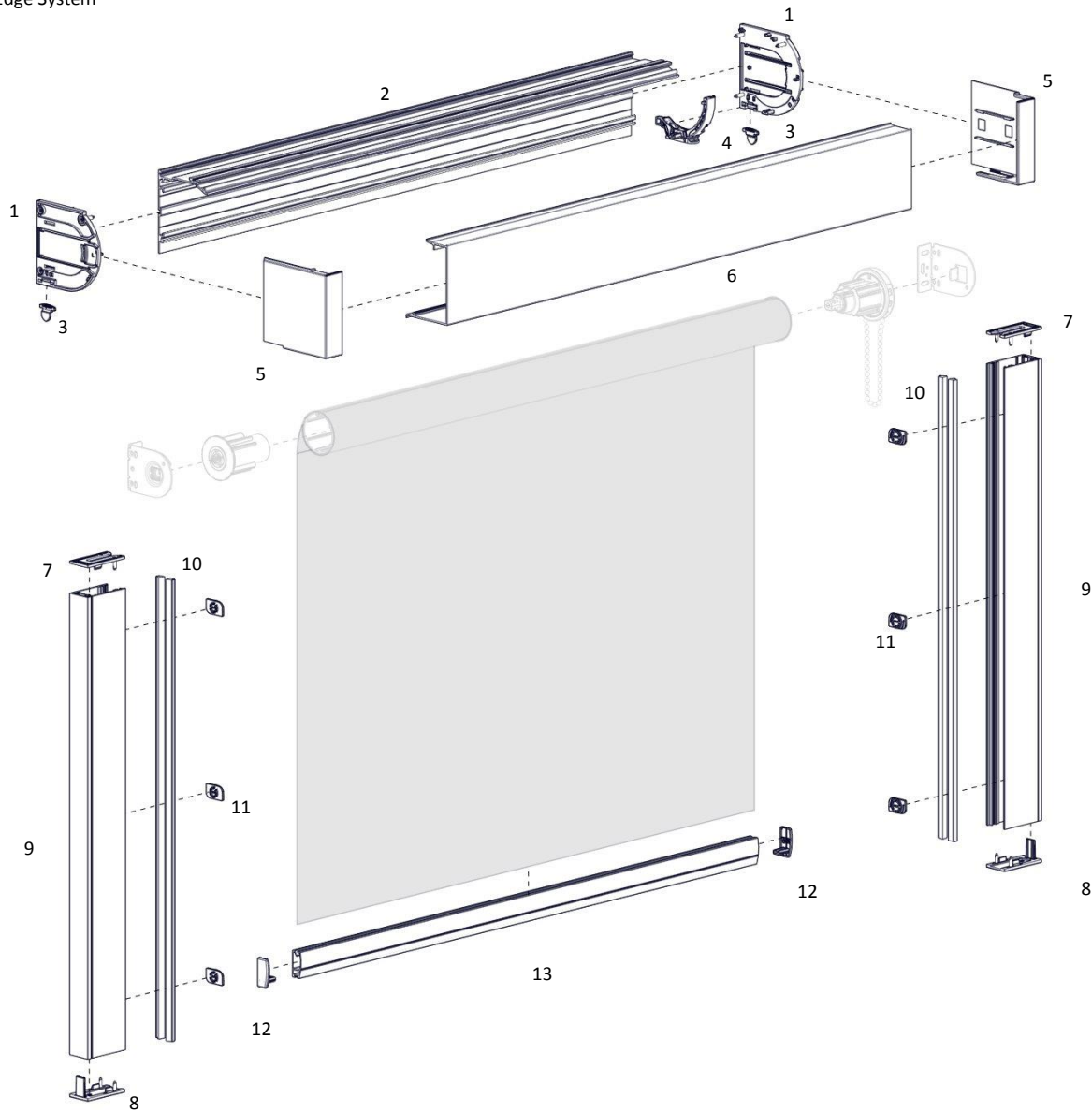

**SYSTEM INDEX**

**CASSETTE 90**

1. Cassette 90 End Plate Set
2. Cassette 90 Back
3. Cassette Side Guide Ear
4. Cassette 90 Square Chain Guide Set
5. Cassette 90 Square End Cap
6. Cassette 90 Square Cover
7. CF90 Edge Side Guide Funnel Set + screws
8. Bottom Cap Set + screws
9. CF90 Edge Side Guide – 2 Piece Set
10. Fabric Brush T Slot Fit - 7mm (0.276") High x 4.8mm (0.189")
11. CF90 Edge Side Guide Lock
12. D30 Bottom Rail End Caps
13. D30 Bottom Rail



## PART B – SYSTEM OPTIONS

### CONTROL OPTIONS

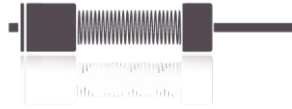
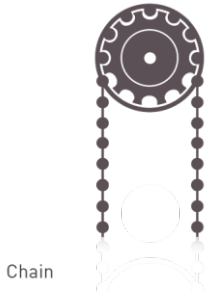

### COLOUR RANGE



pure white  
069



anodized  
020



black  
050

## PART C – PRODUCT OPTIONS

### FASCIA

Round Fascia

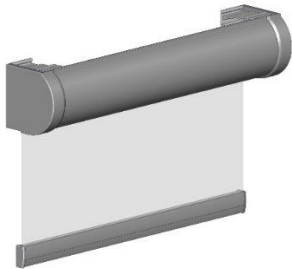

Square Fascia

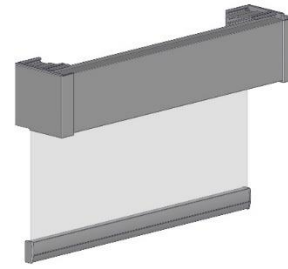

### BRACKETS

Cassette 90 – Wall Mount



Cassette 90 – Ceiling Mount

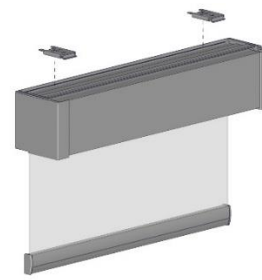

PART D – SYSTEM UPGRADES

CF CASSETTE/FASCIA - EASY-LINK

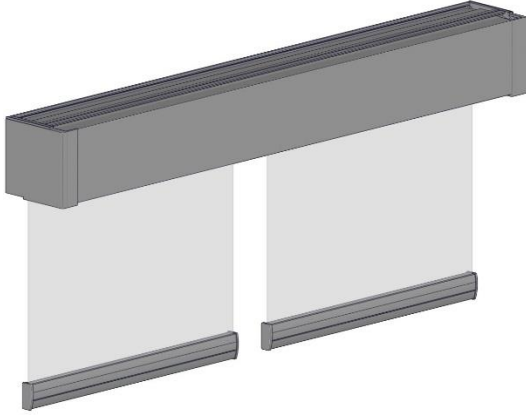

CF CASSETTE/FASCIA CF90 EDGE - EASY-LINK

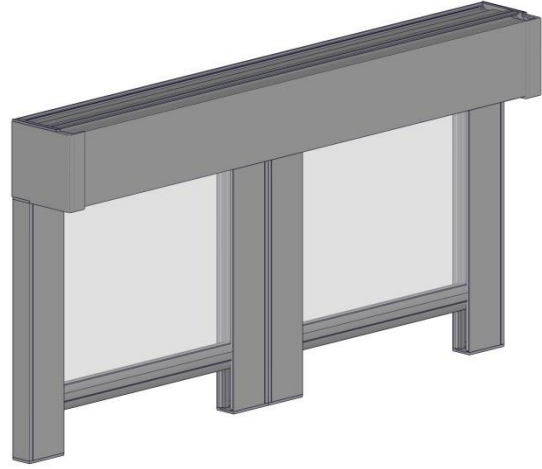

**SECTION 2 – SYSTEM SPECIFICATIONS**

**PART A – CASSETTE 90 SPRING CAPACITY**

**S45 LT TUBE**

Drop (ft)	Width (ft)																	
	2.0	2.6	3.3	3.9	4.6	5.2	5.9	6.6	7.2	7.9	8.5	9.2	9.8	10.5	11.2	11.8	12.5	13.1
1.6																		
2.0																		
2.3																		
2.6																		
3.0																		
3.3																		
3.6																		
3.9																		
4.3																		
4.6																		
4.9																		
5.3																		
5.6																		
5.9																		
6.2																		
6.6																		
6.9																		
7.2																		
7.5																		
7.9																		
8.2																		
8.5																		
8.9																		
9.2																		
9.5																		
9.8																		
10.2																		
10.5																		
10.8																		
11.2																		
11.5																		
11.8																		
12.1																		
12.5																		
12.8																		
13.1																		







LEGEND	DESCRIPTION
	S45 Universal Booster - Short
	S45 Universal Booster - Light
	S45 Universal Booster - Standard
	S45 Universal Booster - Standard with Easy Link
	S45 Universal Booster - Heavy Duty with Easy Link
	Cannot be achieved - outside product specifications

**NOTE:** The above chart is based on 13.27oz/yd<sup>2</sup> fabric, 0.02" thick, D30 Medium weight bar, (no ballast)



## S45 STD TUBE

Drop (ft)	Width (ft)																	
	2.0	2.6	3.3	3.9	4.6	5.2	5.9	6.6	7.2	7.9	8.5	9.2	9.8	10.5	11.2	11.8	12.5	13.1
1.6																		
2.0																		
2.3																		
2.6																		
3.0																		
3.3																		
3.6																		
3.9																		
4.3																		
4.6																		
4.9																		
5.3																		
5.6																		
5.9																		
6.2																		
6.6																		
6.9																		
7.2																		
7.5																		
7.9																		
8.2																		
8.5																		
8.9																		
9.2																		
9.5																		
9.8																		
10.2																		
10.5																		
10.8																		
11.2																		
11.5																		
11.8																		
12.1																		
12.5																		
12.8																		
13.1																		

LEGEND	DESCRIPTION
	S45 Universal Booster - Short
	S45 Universal Booster - Light
	S45 Universal Booster - Standard
	S45 Universal Booster - Heavy Duty
	S45 Universal Booster - Standard with Easy Link
	S45 Universal Booster - Heavy Duty with Easy Link
	Cannot be achieved - outside product specifications





**NOTE:** The above chart is based on 13.27oz/yd<sup>2</sup> fabric, 0.02" thick, D30 Medium weight bar, (no ballast)



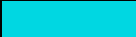

## S45 HD TUBE

Drop (ft)	Width (ft)																	
	2.0	2.6	3.3	3.9	4.6	5.2	5.9	6.6	7.2	7.9	8.5	9.2	9.8	10.5	11.2	11.8	12.5	13.1
1.6																		
2.0																		
2.3																		
2.6																		
3.0																		
3.3																		
3.6																		
3.9																		
4.3																		
4.6																		
4.9																		
5.3																		
5.6																		
5.9																		
6.2																		
6.6																		
6.9																		
7.2																		
7.5																		
7.9																		
8.2																		
8.5																		
8.9																		
9.2																		
9.5																		
9.8																		
10.2																		
10.5																		
10.8																		
11.2																		
11.5																		
11.8																		
12.1																		
12.5																		
12.8																		
13.1																		

LEGEND	DESCRIPTION
	S45 Universal Booster - Short
	S45 Universal Booster - Light
	S45 Universal Booster - Standard
	S45 Universal Booster - Heavy Duty
	S45 Universal Booster - Heavy Duty with Easy Link
	Cannot be achieved - outside product specifications

**NOTE:** The above chart is based on 13.27oz/yd<sup>2</sup> fabric, 0.02" thick, D30 Medium weight bar, (no ballast)



PART B – CASSETTE 90 CHAIN CONTROL CAPACITY

**RB09 CHAINWINDER | S45 SYSTEM**

Drop (ft)	Width (ft)																			
	0.7	1.3	2.0	2.6	3.3	3.9	4.6	5.2	5.9	6.6	7.2	7.9	8.5	9.2	9.8	10.5	11.2	11.8	12.5	13.1
1.6																				
2.0																				
2.3																				
2.6																				
3.0																				
3.3																				
3.6																				
3.9																				
4.3																				
4.6																				
4.9																				
5.2																				
5.6																				
5.9																				
6.2																				
6.6																				
6.9																				
7.2																				
7.5																				
7.9																				
8.2																				
8.5																				
8.9																				
9.2																				
9.5																				
9.8																				
10.2																				
10.5																				
10.8																				
11.2																				
11.5																				
11.8																				
12.1																				
12.5																				
12.8																				
13.1																				

LEGEND	DESCRIPTION
	RB09   S45   All Tubes
	RB09   S45   STD + HD Tubes
	RB09   S45   HD Tube
	S45 Easy-Link
	Cannot be achieved - outside product specifications

**NOTE:** The above chart is based on 13.27oz/yd<sup>2</sup> fabric, 0.02" thick, D30 medium bottom rail, (no ballast)



PART C – CASSETTE 90 CHAIN CONTROL + RETROFIT BOOSTER CAPACITY

RB09 CHAINWINDER | S45 LT TUBE

		Width (ft)																				
Wraps	Drop (ft)	0.7	1.3	2.0	2.6	3.3	3.9	4.6	5.2	5.9	6.6	7.2	7.9	8.5	9.2	9.8	10.5	11.2	11.8	12.5	13.1	
4	1.6																					
4	2.0																					
5	2.3																					
6	2.6																					
6	3.0																					
7	3.3																					
7	3.6																					
8	3.9																					
9	4.3																					
9	4.6																					
10	4.9																					
10	5.2																					
11	5.6																					
12	5.9																					
12	6.2																					
13	6.6																					
13	6.9																					
14	7.2																					
14	7.5																					
15	7.9																					
16	8.2																					
16	8.5																					
17	8.9																					
17	9.2																					
18	9.5																					
18	9.8																					
19	10.2																					
19	10.5																					
20	10.8																					
20	11.2																					
21	11.5																					
21	11.8																					
22	12.1																					
22	12.5																					
23	12.8																					
23	13.1																					

LEGEND	DESCRIPTION
	RB09 Chainwinder + Standard Retrofit Booster
	RB09 Chainwinder + Heavy Duty Retrofit Booster
	RB09 Chainwinder + Heavy Duty Retrofit Booster with Easy-Link
	Cannot be achieved - outside product specifications

**NOTE:** The above chart is based on on 13.27oz/yd<sup>2</sup> fabric, 0.02" thick, Round bottom rail, (no ballast)

## RB09 CHAINWINDER | S45 STD TUBE

Wraps	Drop (ft)	Width (ft)																			
		0.7	1.3	2.0	2.6	3.3	3.9	4.6	5.2	5.9	6.6	7.2	7.9	8.5	9.2	9.8	10.5	11.2	11.8	12.5	13.1
4	1.6																				
4	2.0																				
5	2.3																				
6	2.6																				
6	3.0																				
7	3.3																				
7	3.6																				
8	3.9																				
9	4.3																				
9	4.6																				
10	4.9																				
10	5.2																				
11	5.6																				
12	5.9																				
12	6.2																				
13	6.6																				
13	6.9																				
14	7.2																				
14	7.5																				
15	7.9																				
16	8.2																				
16	8.5																				
17	8.9																				
17	9.2																				
18	9.5																				
18	9.8																				
19	10.2																				
19	10.5																				
20	10.8																				
20	11.2																				
21	11.5																				
21	11.8																				
22	12.1																				
22	12.5																				
23	12.8																				
23	13.1																				

LEGEND	DESCRIPTION
	RB09 Chainwinder + Standard Retrofit Booster
	RB09 Chainwinder + Heavy Duty Retrofit Booster
	RB09 Chainwinder + Heavy Duty Retrofit Booster with Easy-Link
	Cannot be achieved - outside product specifications

**NOTE:** The above chart is based on 13.27oz/yd<sup>2</sup> fabric, 0.02" thick, Round bottom rail, (no ballast)



## RB09 CHAINWINDER | S45 HD TUBE

Wraps	Drop (ft)	Width (ft)																			
		0.7	1.3	2.0	2.6	3.3	3.9	4.6	5.2	5.9	6.6	7.2	7.9	8.5	9.2	9.8	10.5	11.2	11.8	12.5	13.1
3	1.6																				
4	2.0																				
4	2.3																				
5	2.6																				
6	3.0																				
6	3.3																				
7	3.6																				
7	3.9																				
8	4.3																				
8	4.6																				
9	4.9																				
10	5.2																				
10	5.6																				
11	5.9																				
11	6.2																				
12	6.6																				
12	6.9																				
13	7.2																				
13	7.5																				
14	7.9																				
14	8.2																				
15	8.5																				
15	8.9																				
16	9.2																				
16	9.5																				
17	9.8																				
17	10.2																				
18	10.5																				
18	10.8																				
19	11.2																				
19	11.5																				
20	11.8																				
20	12.1																				
21	12.5																				
21	12.8																				
21	13.1																				

LEGEND	DESCRIPTION
	RB09 Chainwinder + Standard Retrofit Booster
	RB09 Chainwinder + Heavy Duty Retrofit Booster
	RB09 Chainwinder + Heavy Duty Retrofit Booster with Easy-Link
	Cannot be achieved - outside product specifications

**NOTE:** The above chart is based on 13.27oz/yd<sup>2</sup> fabric, 0.02" thick, Round bottom rail, (no ballast)



## SECTION 3 – TEST SUMMARY

### TEST – CYCLE

<b>TEST DESCRIPTION:</b>	<b>CASSETTE 90 CHAIN GUIDE</b>	<b>TEST REPORT NUMBER:</b>	TR-2015021
<b>CYCLES PASSED:</b>	10,000	<b>TORQUE:</b>	N/A
<b>BRACKET INSTALLATION:</b>	Direct Mount	<b>WIRE / SIDE GUIDE INSTALLATION:</b>	N/A

### TEST – PRODUCT EVALUATION (FABRICATION, INSTALLATION, OPERATIONAL)

<b>TEST DESCRIPTION:</b>	CASSETTE 90 CF90 Edge	<b>PRODUCT LOCATION:</b>	R&T
<b>SHADE WIDTH (mm):</b>	1200	<b>SHADE DROP (mm):</b>	1500
<b>CONTROL:</b>	Chain Control	<b>FABRIC:</b>	Balmoral – Blockout 11.5oz/yd <sup>2</sup>
<b>BRACKET INSTALLATION:</b>	Direct Mount	<b>WIRE / SIDE GUIDE INSTALLATION:</b>	CF90 Edge



## SECTION 4 – MATERIAL SPECIFICATIONS

PART NUMBER	PRODUCT	MATERIAL	METAL FINISHES
RC02-0101-XXX090	CASSETTE 90 END PLATE SET + SCREWS	POM/STEEL	Z/P (SCREW)
RC01-0101-XXX480	CASSETTE 90 BACK	ALUMINUM	ANODIZED 15µm MIN DEPTH P/COAT MAX 0.1mm
RC02-0102-XXX090	CASSETTE 90 ROUND END COVER SET	ABS+PC	N/A
RC01-0102-XXX480	CASSETTE 90 ROUND COVER	ALUMINUM	ANODIZED 15µm MIN DEPTH P/COAT MAX 0.1mm
RC02-0201-XXX090	CASSETTE 90 ROUND CHAIN GUIDE SET	ABS+PU	N/A
RC02-0202-XXX090	CASSETTE 90 SQUARE CHAIN GUIDE SET	ABS+PU	N/A
RC02-0103-XXX090	CASSETTE 90 SQUARE END COVER SET	ABS+PC	N/A
RC01-0103-XXX480	CASSETTE 90 SQUARE COVER	ALUMINUM	ANODIZED 15µm MIN DEPTH P/COAT MAX 0.1mm
RC91-1002-XXX000	CF90 EDGE SIDE GUIDE FUNNEL & SCREW SET	POM + STEEL	N/A
RC91-0302-XXX000	CASSETTE SIDE GUIDE EAR	POM	N/A
RB91-1232-XXX580	D30 SILENT BOTTOM RAIL	ALUMINUM	ANODIZED 15µm MIN DEPTH P/COAT MAX 0.1mm
RB91-2131-XXX002	D30 BOTTOM RAIL END CAPS	POM	N/A
RC91-1001-XXX000	BOTTOM CAP + SCREWS	POM + STEEL	N/A
RC91-0101-XXX580	CF90 EDGE SIDE GUIDE – 2 PIECE SET	ALUMINUM	ANODIZED 15µm MIN DEPTH P/COAT MAX 0.1mm
RC91-0302-XXX000	CASSETTE SIDE GUIDE EAR	POM	N/A
RC91-0201-XXX000	CF90 EDGE SIDE GUIDE LOCK	POM	N/A
RC03-1001-XXX090	CASSETTE 90 MOUNTING BRACKET/TOP FIX/CEILING MOUNT	STEEL	Z/P
AW91-1501-XXX000	FABRIC BRUSH T-SLOT FIT	PP	N/A
RC03-1002-XXX090	CASSETTE 90 MOUNTING BRACKET/FACE FIX/WALL MOUNT	STEEL	ANODIZED 15µm MIN DEPTH P/COAT MAX 0.1mm
RC03-0101-XXX040	FASCIA 90 BRACKET – 40MM	ALUMINUM	ANODIZED 15µm MIN DEPTH P/COAT MAX 0.1mm



## SECTION 5 – WARRANTY

Rollease Acmeda provides a 5 year hardware warranty against defects to the original purchaser (the fabricator/manufacturer).

The hardware warranty is not to be transferred to the end consumer.

The hardware warranty is limited to the repair or resupply of defective hardware components to the fabricator/manufacturer only.

The hardware warranty is applicable to normal use.

The hardware warranty will not apply where the defect arises due to incorrect assembly and installation.

Retailers are obliged to supply consumers with their own warranty, if required, at the point of purchase.





## SECTION 6 – SPECIFICATION IMAGES

Please contact Rollease Acmeda: [marketing@rolleaseacmeda.com](mailto:marketing@rolleaseacmeda.com) to request electronic copies of the file listed below.

### PART A – SHADE DEDUCTIONS

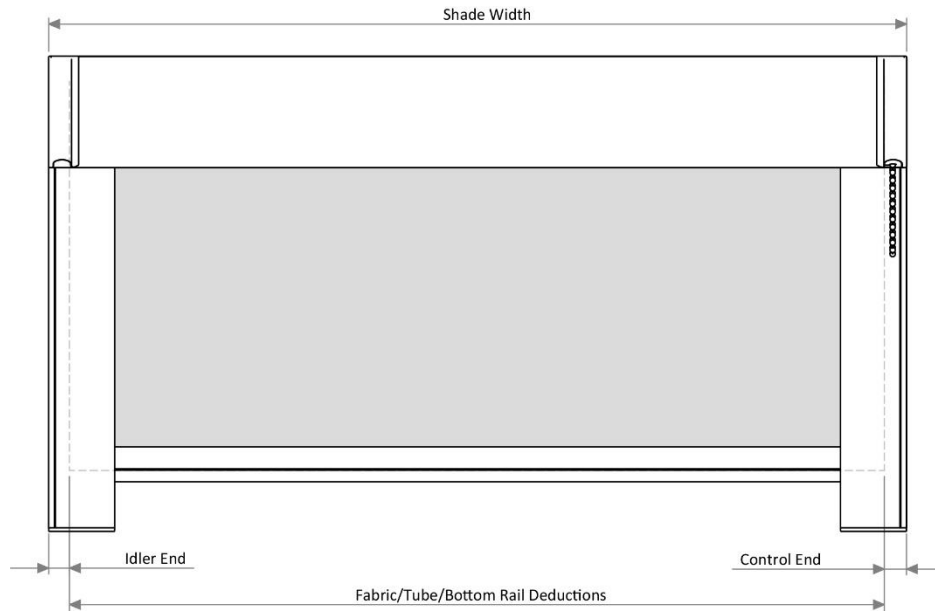

FA FABRIC / TUBE / HEM BAR DEDUCTIONS BRIC / TUBE / HEM BAR DEDUCTIONS								
CASSETTE	PIN END	CONTROL END						
		SPRING	MOTOR			CLUTCH		
90	Easy Spring Plus Limiter	RB09	Skyline	Easy Spring Plus	Wirefree Motor	S45 EL / ML Motor	RB09	Skyline
	20mm (0.787")	19mm (0.748")	19mm* (0.748")	19mm (0.748")	19mm (0.748")	26mm (0.709")	18mm (0.709")	21mm (0.827")

\*Add 1mm (0.039") for HD Pin End.

### PART B – EASY-LINK ADDITIONAL DEDUCTION ALLOWANCE (CASSETTE 90 ONLY)

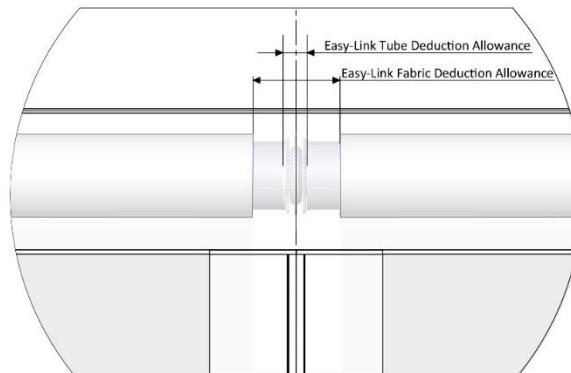

	FABRIC	TUBE
PLAIN CASSETTE	17mm (0.66")	17mm (0.66")
CF90 Edge	40mm (1.57")	17mm (0.66")



**PART C – MAXIMUM ROLL DIAMETERS**

**Cassette 90**

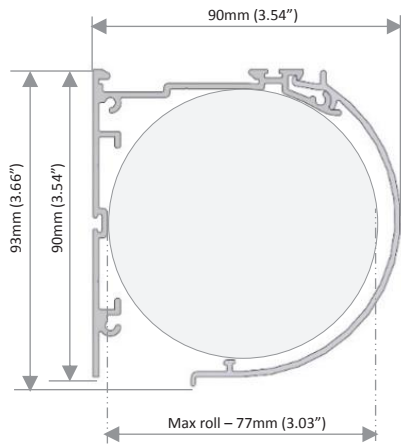

**Round Cassette**

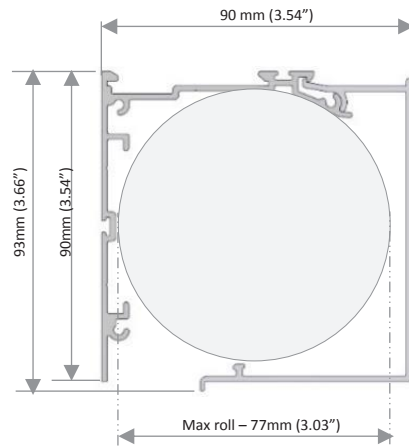

**Square Cassette**

**PART D – BRACKET DIMENSIONS**

**Cassette 90**

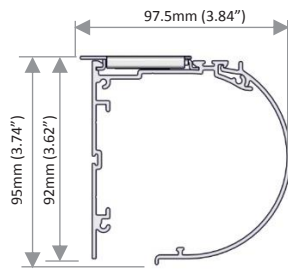

**RC03-1001-xxx090**

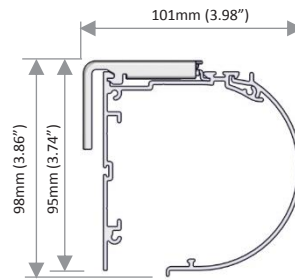

**RC03-1002-xxx090**



PART E – ARCHITECTURAL VIEWS

Cassette 90

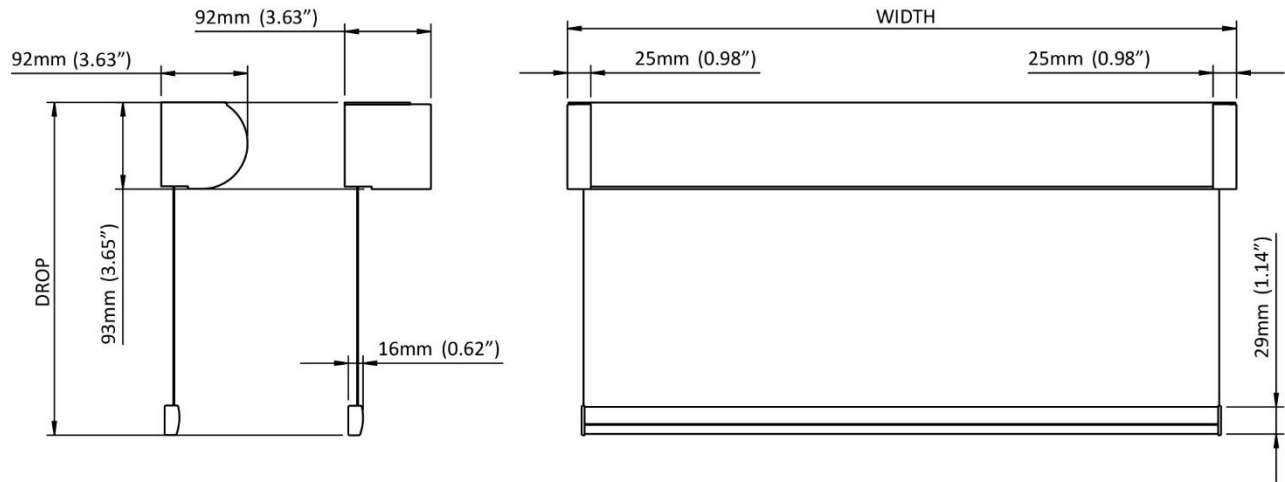

Filename: Arch Specs CF90

Cassette 90 –CF90 Edge

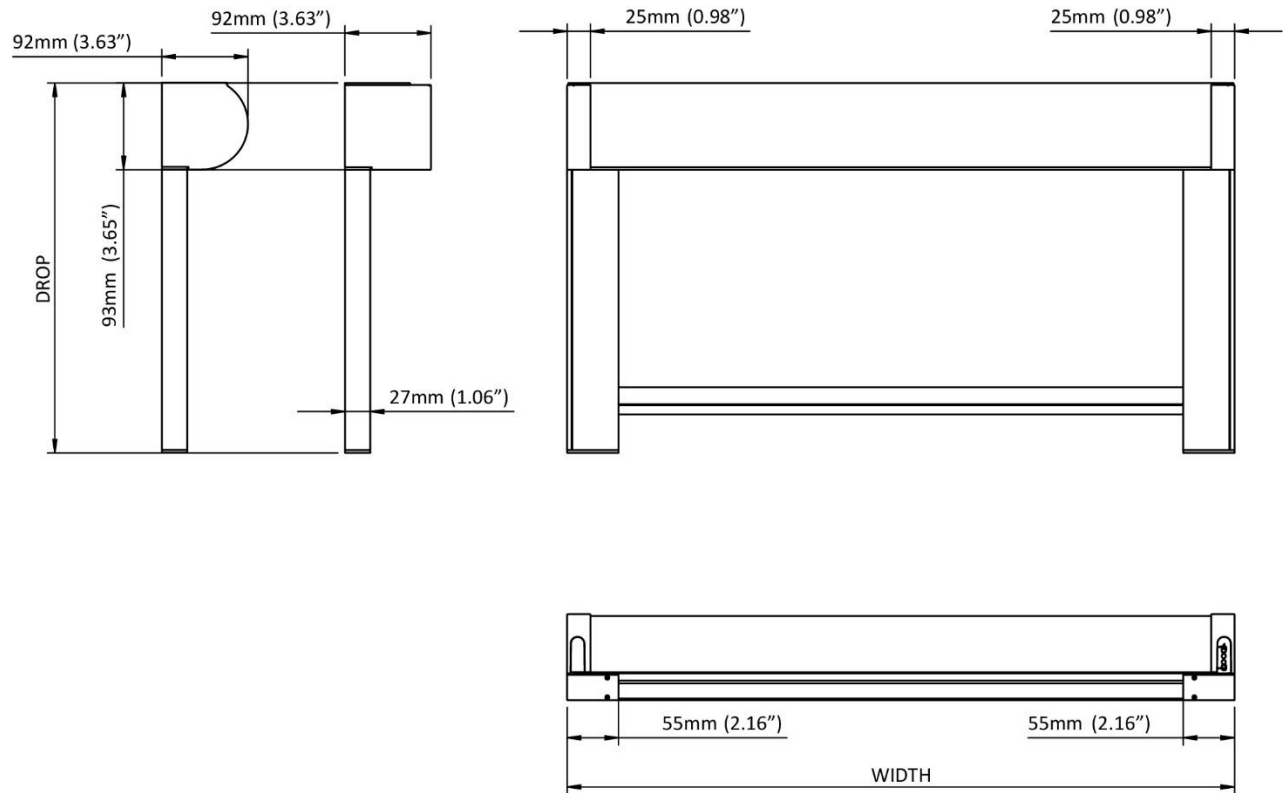

Filename: Arch Specs CF90



**SECTION 7 - PRODUCT IMAGERY**

		
Filename: CAS CF Photo Blnd_001	Filename: CAS CF Photo Blnd_002	Filename: CAS CF Photo Blnd_003
		
Filename: CAS CF Photo Blnd_004		



## SECTION 8 – MEASURE & SPECIFY

### MEASURE & SPECIFY GUIDELINES

In order to assist with providing seamless communication between the Specifier, Assembler and Installer Rollease Acmeda provide some guidelines to assist with measuring and specifying the Cassette Roller System in order to:

- Identify key information for Assembler and Installer
- Improve efficiency
- Limit the number of re-calls / adjustment required onsite after installation

The suggested 'Actual Shade Sizes' are based on:

- Minimum clearances to assist installers  
(some installers may request greater clearances for some application, e.g. installing onto brick)

### MEASURING TIPS

#### TIP 1: CHECK TOP OF INSTALLATION SPACE IS LEVEL

If Top of Installation Space is uneven, ensure 'Top Width' measurement and all 'Drop' measurements are taken from 'Lowest Top Point' (dotted line indicated below)

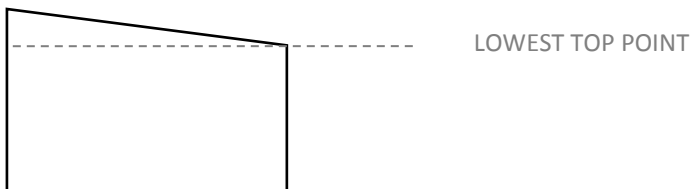

#### TIP 2: FOR SHADE INSTALLATIONS, TAKE NOTE OF MEASUREMENTS BELOW -

Installation Width at Top, Bottom (and Center for CF90 Edge installations only)

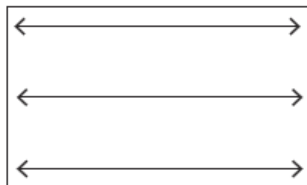



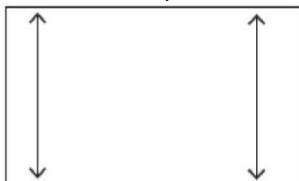

Installation drop at Left and Right.



For best installation and operation results, it is favorable for the measurements to be within:

- 5mm (0.197") of each other for CF90 Edge Installations.
- 15mm of each (0.591") other for plain cassette/fascia installations.

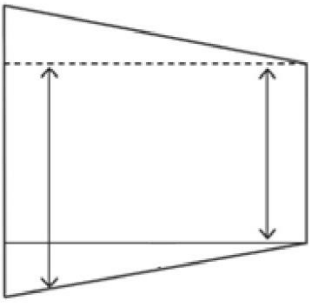

SHADE DROP	EXAMPLE
<p>For all scenarios</p> <p>Top &amp; Bottom level</p>  <p>Top uneven &amp; Bottom level</p>  <p>Top level &amp; Bottom uneven^</p>  <p>Top &amp; Bottom uneven^</p>  <p><b>Shade Drop = Smallest Drop Size</b></p>	<p>Top &amp; Bottom uneven</p>  <p><b>Shade Drop = Smallest Drop Size = Right Hand Drop Size 2000mm (78.740")</b></p>

**For CF90 Edge Shade installations**

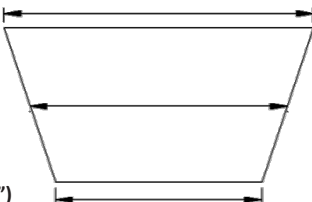
SHADE WIDTH	EXAMPLE
<p>Top width must be larger than or equal to Bottom Width</p>  <p>If measured width (at top) is larger than width at bottom Shade Width = bottom width</p>	 <p>TOP 2016mm (79.370")</p> <p>CENTER 2008mm (79.055")</p> <p>BOTTOM 2000mm (78.740")</p> <p><b>Shade Width = 2000mm (78.740")</b></p>

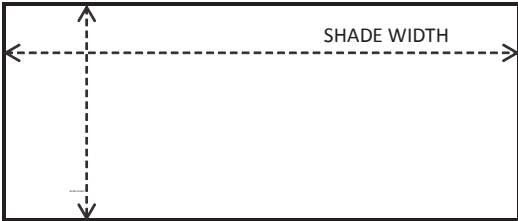

CUSTOMER DETAILS	
Customer's Name:	
Job Number:	

INSTALLATION SPACE									
	<table border="1"> <tr> <td></td> <td>TOP WIDTH (mm)</td> </tr> <tr> <td></td> <td>CENTER WIDTH (mm)</td> </tr> <tr> <td></td> <td>BOTTOM WIDTH (mm)</td> </tr> <tr> <td></td> <td>PACKING REQUIRED? Y/N</td> </tr> </table>		TOP WIDTH (mm)		CENTER WIDTH (mm)		BOTTOM WIDTH (mm)		PACKING REQUIRED? Y/N
	TOP WIDTH (mm)								
	CENTER WIDTH (mm)								
	BOTTOM WIDTH (mm)								
	PACKING REQUIRED? Y/N								
<table border="1"> <tr> <td></td> <td>Left Drop (")</td> </tr> <tr> <td></td> <td>Right Drop (")</td> </tr> </table>		Left Drop (")		Right Drop (")					
	Left Drop (")								
	Right Drop (")								

ACTUAL SHADE SIZE	
SHADE WIDTH (")	<input type="text"/>
SHADE HEIGHT (")	<input type="text"/>

INSTALLATION DETAILS	
Number of Shades?	<input type="text"/>
Wall / Ceiling Mount?	<input type="text"/>
Building surface system is being fixed to?	<input type="text"/>
Do any window trims need attention?	<input type="text"/>



**SHADE DETAILS**

CASSETTE SIZE	
CASSETTE 90	<input type="text"/>
ALUMINUM TUBE TYPE	
S45  SPLINE	<input type="text"/>
S45  STD (T-Spline)	<input type="text"/>
S45  HD	<input type="text"/>
SIDE GUIDE TYPE	
CF90 EDGE	<input type="text"/>

CONTROL SIDE	
LEFT HAND	<input type="text"/>
RIGHT HAND	<input type="text"/>
CONTROL TYPE	
S45 RB09 CHAINWINDER	<input type="text"/>
S45 RB40 MOTORIZED	<input type="text"/>
S45 RB01 SPRING	<input type="text"/>
WEIGHT BAR TYPE	
D30	<input type="text"/>
SYSTEM COLOR	
<input type="text"/>	
FABRIC TYPE & COLOR	
<input type="text"/>	

